

User Manual
V6 Grab-n-Go™ Digital Hearing Aid

TV·Ears V6 Grab-n-Go™ Hearing Aid Includes:



TV·EARS®
Voice Clarifying Devices

To activate your 5 Year limited warranty:

Call: 1-888-883-3277
Go online: tvears.com/warranty
Or Mail to: TV Ears, Inc.
2701 Via Orange Way, Suite 1
Spring Valley, CA 91978

tvears.com
[Facebook.com/tvearsinc](https://facebook.com/tvearsinc)
Twitter: [@tvears](https://twitter.com/tvears)

1-888-883-3277 — Sales Main Line
1-866-611-9934 — Support
1-888-958-7899 — Fax
info@tvears.com — Email

Instructional Videos available: tvears.com/instructional-videos

V6 Grab-n-Go™ Hearing Aid
1x Hearing Aid



Magic Domes

- 1x 10mm magic dome
- 1x 12mm magic dome



Foam Dome

- 1x 9mm memory foam dome



Open Domes

- 1x 9mm Open dome
- 1x 12mm Open dome



Closed Domes

- 1x 9mm Closed dome
- 1x 12mm Closed dome
- 1x 15mm Closed dome



Cleaning Tools

- 1x Cleaning Brush
- 1x Cleaning wire



Sound Tube

- 2x 2L tube or 2x 2R tube

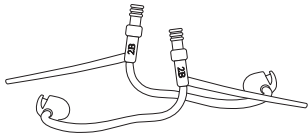

A Clean Hearing Aid is Most Important!
Instructions for Cleaning & Changing the Sound Tube:

Cleaning:

Use a soft cloth to wipe the hearing aid after use to remove any particles or possible moisture. The Cleaning Tool provided in your kit is used to remove debris or wax from the sound tube and dome tip. It is recommended that the dome tips be wiped clean every other day. For best results, we suggest soaking **JUST** the dome tip in a bowl of warm water and dish soap every month or two months;.

Changing the Sound Tube:

1. To remove the tube, gently unscrew the tube from the processor mount.
2. Pull the sound tube from the hearing aid.
3. To clean, insert the black cleaning wire through the length of the sound tube in order to push free any wax blockage.
4. To reassemble, screw the sound tube back on the threads of the processor.

*This should be done at least every other week for optimal performance.

TV·Ears V6 Grab-n-Go™ Digital Hearing Aid

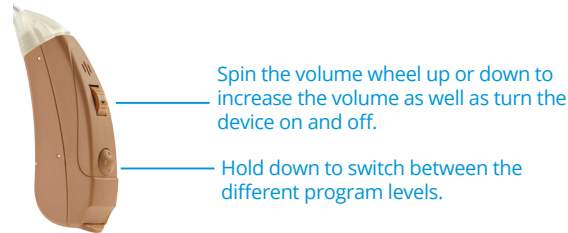
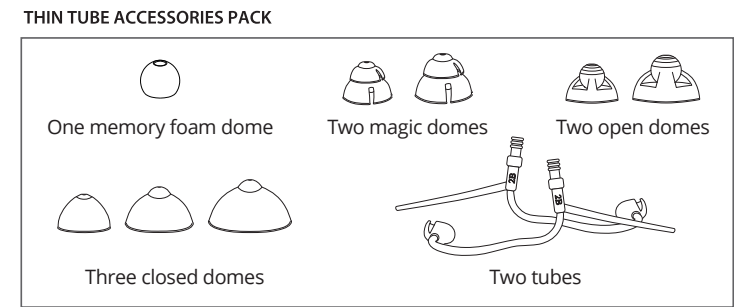

Features

Volume Control

The volume can be adjusted up or down.
Simply adjust the volume wheel up or down to increase or decrease.

On/Off

The volume wheel also turns the device on and off.

Program Switch

Press and hold either part of the switch for 3 seconds to change the current program.

Four Pre-Set Program Levels!

- Program 1: Normal, Universal Use
- Program 2: Noise Reduction, Dual Microphone
- Program 3: Noise Reduction, Single Microphone
- Program 4: Severe Noise Mode, Dual Microphone

Operation

Turning your Hearing Aid On/Off

Your Hearing Aid has two different ways it can be turned on and off. The device automatically turns ON whenever the battery door compartment is closed and OFF when the battery door is opened. Additionally, the power can be controlled by the volume wheel. Turn the wheel all the way down to '0' and the device will turn off. This eliminates the need to open and close the battery door. To turn back on, slide the volume wheel up from '0' to increase the volume and the device will power on after a 3 second delay,

To insert a battery

- ▶ Open the Battery Compartment Door by gently swinging it into the open position.
- ▶ Remove the tab from a new #13 size battery.
- ▶ Place the new battery in the Battery Compartment Door with the positive (+) or flat side up as pictured.
- ▶ Close the battery compartment door until you hear it click

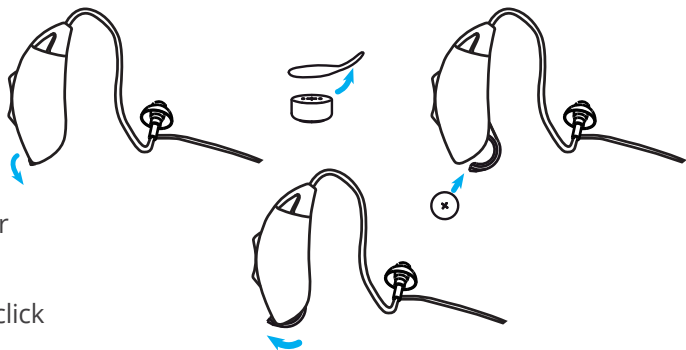

Put on your Hearing Aid

Before putting on your Hearing Aid, please clean your ear and make sure the battery door is closed properly. Follow the procedure for inserting your Hearing Aid.

- Step 1:** Hold the sound tube
- Step 2:** Place the Hearing Aid over the top of the ear.
- Step 3:** Gently insert the dome into ear canal.
- Step 4:** Move the retention lock and place it into the bowl of your ear.



Help with Whistling

Whistling may occur if the Hearing Aid is turned on, but not securely seated in your ear. This is normal. The whistling will stop once the Hearing Aid is properly seated in your ear. Other causes include a blockage of wax, or damaged ear piece or tubing, or excessive volume. Please take appropriate measures to stop the whistling.

Find the Perfect Fit!

Your new hearing aid comes with a variety of dome tips. Use this guide to find the best fit for you.

Magic Domes

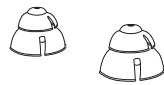

Medium Magic Dome comes pre-attached on your Hearing Aids. This tip is a mix of an Open and a Closed dome tip. It is best for first time users. Louder than an Open, yet quieter than a Closed.

Open Domes



Best for mild amplification. Overall better quality of sound. Good for the very common higher frequency losses.

Closed Domes



Best for moderate to severe amplification. Helps with background noise reduction. Overall louder sound. Helps eliminate feedback on higher volume levels.

Foam Dome



Best for very mild amplification and issues with volume being too loud.

Dome

Attach the dome

Push the dome over the grooves on the tubes to mount it.

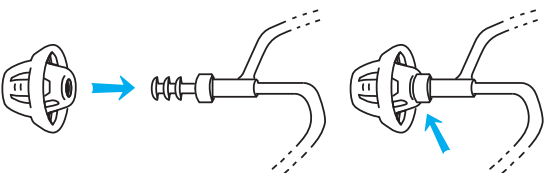

Need more Dome Tips?

For best use, it is recommended that the dome tips be changed on a monthly basis. To order more dome tips, please give us a call at 1 (888) 883-3277